



EXTENDUM **T8**

**Tube light Data Sheet s**  
**Extendum T10**  
**Extendum T8**  
**Extendum Fx**



The Extendum T8 is the ideal LED replacement for conventional fluorescent tube lights. U-Tron's signature design allows for a brightness that is equal to traditional bulbs, with consistent coverage. The Extendum is the perfect solution for general lighting applications

U-Tron (Beijing) Electronics Co. Ltd.,

**Our Vision**

To be a company exercising leadership in applying high technology to improving the quality of life and protecting the environment.

**Our Mission**

U-Tron is a customer-focused provider of innovative solutions for the Communication, Lighting, and Transportation markets. We are committed to employing advanced technologies with the highest level of quality, service and value to our family of employees, customers and suppliers through a process of continuous improvement.

**Our Promise**

U-Tron promises leading-edge solutions with superior customer service, and delivers the highest quality products built with integrity and pride.

**Who we are**

We are an Engineering company specializing in Telecommunications, Intelligent Transportation Systems, and Data, Voice and Video transmission. We design, develop and manufacture High Power LED luminaries to serve the ITS and other applications.

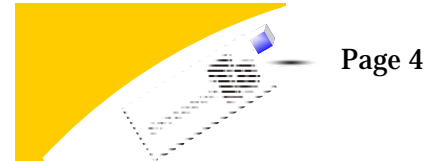

**Extendum T8 Fx 6W 300mm**

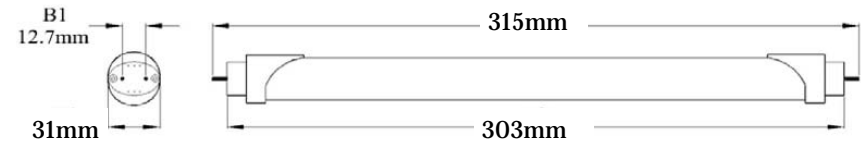

General Information	
Life Span	50000hr
Driver	Internal IP 64 Driver
Cap Size	G13
Electrical Characteristics	
Wattage	6
Voltage	universal
Power Factor	0.926
Temperature	
Operating Temp.	-40(min), 45(max)C
Storage	-40(min), 65(max)C

Light Characteristics	
Efficacy	130lm/W
Beam Angle	160 D
CCT	2700-3000K, 4500-5000K
Flux	780lm
Color Rendering Index	75
Product Dimensions	
Distance between connect-or pins	12.7mm
Outer Diameter	26mm
Inner Diameter	28mm
Length from end to end	313mm

Ordering Information						
Product Name	Extendum T8 <b>6W</b> 300mm G13 <b>Cool White</b> Frosted Cover	Extendum T8 <b>6W</b> 300mm G13 <b>Natural White</b> Frosted Cover	Extendum T8 <b>6W</b> 300mm G13 <b>Warm White</b> Frosted Cover	Extendum T8 <b>6W</b> 300mm G13 <b>Cool White</b> Clear Cover	Extendum T8 <b>6W</b> 300mm G13 <b>Natural White</b> Clear Cover	Extendum T8 <b>6W</b> 300mm G13 <b>Warm White</b> Clear Cover
Product #	68T8-040-06 <b>C3F</b>	68T8-040-06 <b>N3F</b>	68T8-040-06 <b>W3F</b>	68T8-040-06 <b>C3C</b>	68T8-040-06 <b>N3C</b>	68T8-040-06 <b>W3C</b>
Barcode	6949606430009	6949606430108	6949606430207	6949606439903	6949606440008	6949606440107

Pieces Per Pack	1
Packs Per Carton	120
Net Weight Per Piece	180 Grams

Safety and Environmental Compliance	
IP Rating	IP 54 Indoor Dry Area
Certifications	UL, CSA, CE, GB7000 and CCC
Manufacturing Standards	GB120543

**For IES Files Downloads, please scan the QR Code here or type in the following link on your browser**

<http://www.u-tron.com/en/downloads/ies-files-for-all-products/IES-Files-Container/Extendum-T8-Tube-Lights/lang,en-gb/>



Proper illumination is essential for the optimization of safety, comfort and productivity in the classrooms; workplace lighting also dictates quality of perception, mood, and performance levels of the students.

The Extendum T8 is the ideal LED replacement for conventional fluorescent tube lights. U-Tron's signature design allows for a brightness that is equal to traditional bulbs, with consistent coverage. The Extendum is the perfect solution for general lighting applications. Especially for those small rooms, where you just need a small Tube Light. This 300mm LED tube light can be used in any small area.



**Extendum T8 11.6W Technical Data**



General Information	
Life Span	50000hr
Driver	Internal IP 64 Driver
Cap Size	G13
Electrical Characteristics	
Wattage	11.6
Voltage	universal
Power Factor	0.926
Temperature	
Operating Temp.	-40(min), 45(max)C
Storage	-40(min), 65(max)C

Light Characteristics	
Efficacy	130lm/W
Beam Angle	160 D
CCT	2700-3000K, 4500-5000K
Flux	1508lm
Color Rendering Index	75
Product Dimensions	
Distance between connector pins	12.7mm
Outer Diameter	26mm
Inner Diameter	28mm
Length from end to end	605

**Ordering Information**

Product Name	Extendum T8 11.6W 600mm G13 Cool White Frosted Cover	Extendum T8 11.6W 600mm G13 Natural White Frosted Cover	Extendum T8 11.6W 600mm G13 Warm White Frosted Cover	Extendum T8 11.6W 600mm G13 Cool White Clear Cover	Extendum T8 11.6W 600mm G13 Natural White Clear Cover	Extendum T8 11.6W 600mm G13 Warm White Clear Cover
Product #	68T8-080-06C11F	68T8-080-06N11F	68T8-080-06W11F	68T8-080-06C11C	68T8-080-06N11C	68T8-080-06W11C
Barcode	6949606430306	6949606430405	6949606430504	6949606439309	6949606439408	6949606439507

Pieces Per Pack	1
Packs Per Carton	60
Net Weight Per Piece	280 Grams

**Safety and Environmental Compliance**

IP Rating	IP 54 Indoor Dry Area
Certifications	UL, CSA, CE, GB7000 and CCC
Manufacturing Standards	GB120543



**Extendum T8 11.6W 600mm**



**For IES Files Downloads, please scan the QR Code here or type in the following link on your browser**

<http://www.u-tron.com/en/downloads/ies-files-for-all-products/IES-Files-Container/Extendum-T8-Tube-Lights/lang,en-gb/>



Proper illumination is essential for the optimization of safety, comfort and productivity in the classrooms; workplace lighting also dictates quality of perception, mood, and performance levels of the students.

The Extendum T8 is the ideal LED replacement for conventional fluorescent tube lights. U-Tron's signature design allows for a brightness that is equal to traditional bulbs, with consistent coverage. The Extendum is the perfect solution for general lighting applications. Especially for those small rooms, where you just need a Medium size Tube Light. This 600mm LED tube light can be used in any small area and even in large areas.

**Extendum T8 Fx 21W Technical Data**

General Information	
Life Span	50000hr
Driver	Internal IP 64 Driver
Cap Size	G13
Electrical Characteristics	
Wattage	21
Voltage	universal
Power Factor	0.926
Temperature	
Operating Temp.	-40(min), 45(max)C
Storage	-40(min), 65(max)C

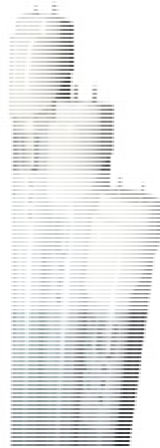

Light Characteristics	
Efficacy	130lm/W
Beam Angle	160 D
CCT	2700-3000K, 4500-5000K
Flux	2730lm
Color Rendering Index	75
Product Dimensions	
Distance between connector pins	12.7mm
Outer Diameter	26mm
Inner Diameter	31mm
Length from end to end	1215mm

Ordering Information						
Product Name	Extendum T8 21W 1200mm G13 Cool White Frosted Cover	Extendum T8 21W 1200mm G13 Natural White Frosted Cover	Extendum T8 21W 1200mm G13 Warm White Frosted Cover	Extendum T8 21W 1200mm G13 Cool White Clear Cover	Extendum T8 21W 1200mm G13 Natural White Clear Cover	Extendum T8 21W 1200mm G13 Warm White Clear Cover
Product #	68T8-160-C1221F	68T8-160-N1221F	68T8-160-W1221F	68T8-160-C1221C	68T8-160-N1221C	68T8-160-W1221C
Barcode	6949606430603	6949606430702	6949606430801	6949606438708	6949606438807	6949606438906

Pieces Per Pack	1
Packs Per Carton	30
Net Weight Per Piece	320 Grams

Safety and Environmental Compliance	
IP Rating	IP 54 Indoor Dry Area
Certifications	UL, CSA, CE, GB7000 and CCC
Manufacturing Standards	GB120543



**Extendum T8 21W 1200mm**

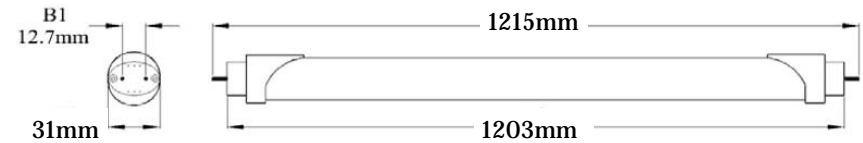

**For IES Files Downloads, please scan the QR Code here or type in the following link on your browser**

<http://www.u-tron.com/en/downloads/ies-files-for-all-products/IES-Files-Container/Extendum-T8-Tube-Lights/lang,en-gb/>



Proper illumination is essential for the optimization of safety, comfort and productivity in the classrooms; workplace lighting also dictates quality of perception, mood, and performance levels of the students.

The Extendum T8 is the ideal LED replacement for conventional fluorescent tube lights. U-Tron's signature design allows for a brightness that is equal to traditional bulbs, with consistent coverage. The Extendum is the perfect solution for general lighting applications. Especially for those medium and large rooms, where you just need a Large size Tube Light. This 1200mm LED tube light can be used in any large areas.



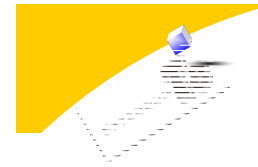

**Extendum T10 21W Technical Data**

General Information	
Life Span	50000hr
Driver	Internal IP 64 Driver
Cap Size	G13
Electrical Characteristics	
Wattage	21
Voltage	universal
Power Factor	0.926
Temperature	
Operating Temp.	-40(min), 45(max)C
Storage	-40(min), 65(max)C

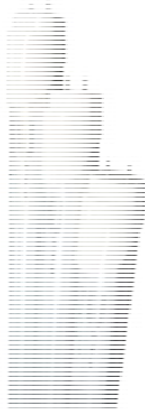

Light Characteristics	
Efficacy	130lm/W
Beam Angle	160 D
CCT	2700-3000K, 4500-5000K
Flux	2730lm
Color Rendering Index	75
Product Dimensions	
Distance between connector pins	12.7mm
Outer Diameter	26mm
Inner Diameter	31mm
Length from end to end	1515mm

Ordering Information						
Product Name	Extendum T8 21W 1500mm G13 Cool White Frosted Cover	Extendum T8 21W 1500mm G13 Natural White Frosted Cover	Extendum T8 21W 1500mm G13 Warm White Frosted Cover	Extendum T8 21W 1500mm G13 Cool White Clear Cover	Extendum T8 21W 1500mm G13 Natural White Clear Cover	Extendum T8 21W 1500mm G13 Warm White Clear Cover
Product #	68T8-160-C1521F	68T8-160-N1521F	68T8-160-W1521F	68T8-160-C1521C	68T8-160-N1521C	68T8-160-W1521C
Barcode	6949606430900	6949606431006	6949606431105	6949606440800	6949606440909	6949606441005

Pieces Per Pack	1
Packs Per Carton	30
Net Weight Per Piece	360 Grams

Safety and Environmental Compliance	
IP Rating	IP 54 Indoor Dry Area
Certifications	UL, CSA, CE, GB7000 and CCC
Manufacturing Standards	GB120543

**Extendum T10 21W 1500mm**

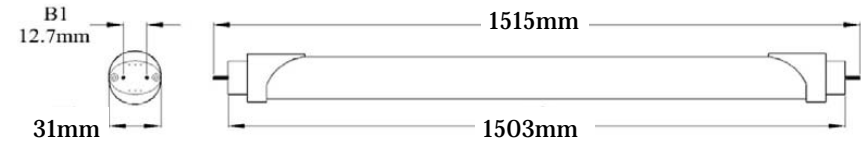

**For IES Files Downloads, please scan the QR Code here or type in the following link on your browser**

<http://www.u-tron.com/en/downloads/ies-files-for-all-products/IES-Files-Container/Extendum-T8-Tube-Lights/lang.en-gb/>



Proper illumination is essential for the optimization of safety, comfort and productivity in the classrooms; workplace lighting also dictates quality of perception, mood, and performance levels of the students.

The Extendum T8 is the ideal LED replacement for conventional fluorescent tube lights. U-Tron's signature design allows for a brightness that is equal to traditional bulbs, with consistent coverage. The Extendum is the perfect solution for general lighting applications. Especially for those medium and large rooms, even in halls and meeting centers, where you just need a Large size Tube Light. This 1500mm LED tube light can be used in any large areas.



**Wiring Diagram:**

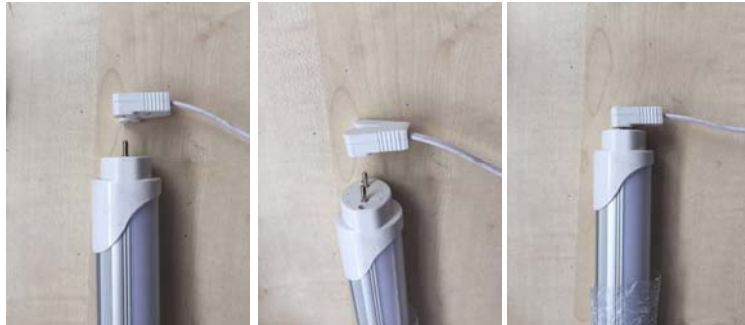

**Installation Instructions:**

1. Simply First remove the plastic protector on the two ends of the tube lights.
2. Now attach the power cable provided by us to the two ends of the tube, make sure the pins are connected properly and firmly.
3. In case of attaching to an tube light holder, which is already set up, insert the Extendum tube light, in the same way as you would do, with a normal tube light. NOTE: make sure the heat sink is facing towards the holder and the cover (where the light will be showing? Facing down towards the room.

This applies to all Extendum Tube light

**Extendum Fx 9W Technical Data**

General Information	
Life Span	50000hr
Driver	Internal IP 67 Driver
Electrical Characteristics	
Wattage	9W
Voltage	universal
Power Factor	0.926
Temperature	
Operating Temp.	-40(min), 45(max)C
Storage	-40(min), 65(max)C



Light Characteristics	
Efficacy	130lm/W
Beam Angle	165 D
CCT	2700-3000K, 4500-5000K
Flux	1170lm
Color Rendering Index	82.3
Product Dimensions	
Height	32mm
Mounting Hole Diameter	32mm
Length from end to end(H1)	600mm

**Ordering Information**

Product Name	Extendum T8 Fx 9W 600mm Cool White Frosted Cover	Extendum T8 Fx 9W 600mm Natural White Frosted Cover	Extendum T8 Fx 9W 600mm Warm White Frosted Cover	Extendum T8 Fx 9W 600mm Cool White Clear Cover	Extendum T8 Fx 9W 600mm Natural White Clear Cover	Extendum T8 Fx 9W 600mm Warm White Clear cover
Product #	68T8-160-6FC9F	68T8-160-6FN9F	68T8-160-6FW9F	68T8-160-6FC9C	68T8-160-6FN9C	68T8-160-6FW9C
Barcode	6.94961E+12	6949606441203	6949606441302	6949606441401	6949606441500	6949606441609

Pieces Per Pack	1
Packs Per Carton	60
Net Weight Per Piece	360 Grams

**Safety and Environmental Compliance**

IP Rating	IP 54 Indoor Dry Area
Certifications	UL, CSA, CE, GB7000 and CCC
Manufacturing Standards	GB120543



## Mechanical and Lighting Description

### Extendum Fx 9W 600mm

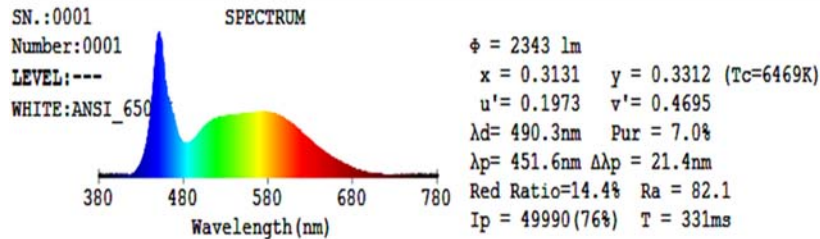
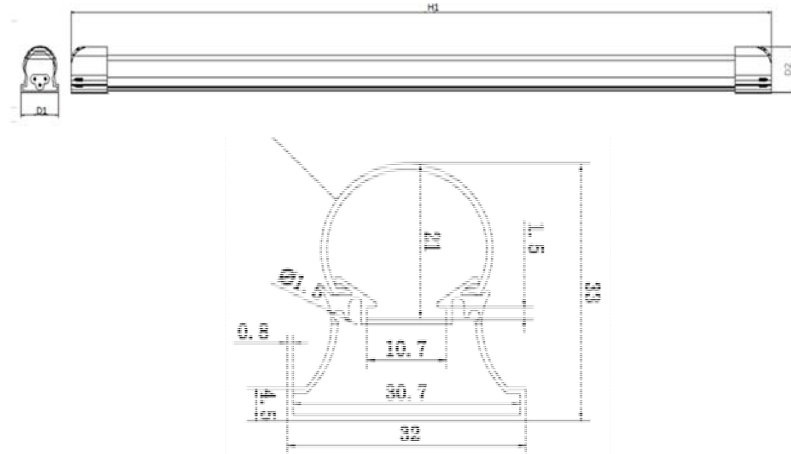

**For IES Files Downloads, please scan the QR Code here or type in the following link on your browser**

<http://www.u-tron.com/en/downloads/ies-files-for-all-products/IES-Files-Container/Extendum-T8-Tube-Lights/lang.en-gb/>



Proper illumination is essential for the optimization of safety, comfort and productivity in the classrooms; workplace lighting also dictates quality of perception, mood, and performance levels of the students.

U-Tron signature Extendum T8 Fx is an all in one solution for all tube light installations. It has its own cover and connectors, thus eliminating the space required to install and casing attachment, like other tube lights. With a length of 600mm, it is ideal for small areas. It is also ideal LED light source for hydroponic systems. Especially for the green vegetables growers. Extendum T8 Fx are sealed for water leakage and current leakage. You can use them in any wet and damp conditions without any fear of safety.

## 68T8-160 Series

### Extendum Fx 18W Technical Data

General Information	
Life Span	50000hr
Driver	Internal IP 67 Driver
Electrical Characteristics	
Wattage	18W
Voltage	universal
Power Factor	0.926
Temperature	
Operating Temp.	-40(min), 45(max)C
Storage	-40(min), 65(max)C



Light Characteristics	
Efficacy	130lm/W
Beam Angle	160 D
CCT	2700-3000K, 4500-5000K
Flux	2340lm
Color Rendering Index	82.3
Product Dimensions	
Height	32mm
Mounting Hole Diameter	32mm
Length from end to end (H1)	1200mm

### Ordering Information

Product Name	Extendum T8 Fx 18W 1200mm Cool White Frosted Cover	Extendum T8 Fx 18W 1200mm Natural White Frosted Cover	Extendum T8 Fx 18W 1200mm Warm White Frosted Cover	Extendum T8 Fx 18W 1200mm Cool White Clear Cover	Extendum T8 Fx 18W 1200mm Natural White Clear Cover	Extendum T8 Fx 18W 1200mm Warm White Clear cover
Product #	68T8-160-12FC18F	68T8-160-12FN18F	68T8-160-12FW18F	68T8-160-12FC18C	68T8-160-12FN18C	68T8-160-12FW18C
Barcode	6.94961E+12	6949606431709	6949606431808	6949606439606	6949606439705	6949606439804

Pieces Per Pack	1
Packs Per Carton	30
Net Weight Per Piece	360 Grams

### Safety and Environmental Compliance

IP Rating	IP 54 Indoor Dry Area
Certifications	UL, CSA, CE, GB7000 and CCC
Manufacturing Standards	GB120543



**Extendum Fx 18W 1200mm**

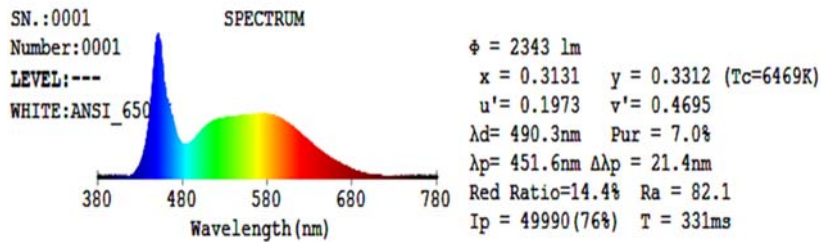
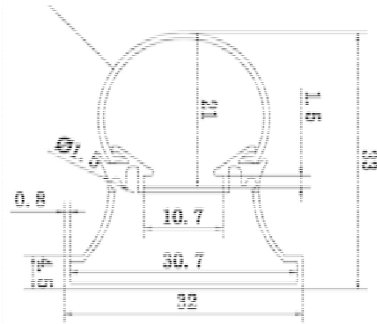
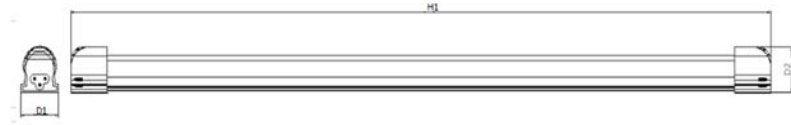

**For IES Files Downloads, please scan the QR Code here or type in the following link on your browser**

<http://www.u-tron.com/en/downloads/ies-files-for-all-products/IES-Files-Container/Extendum-T8-Tube-Lights/lang.en-gb/>



Proper illumination is essential for the optimization of safety, comfort and productivity in the classrooms; workplace lighting also dictates quality of perception, mood, and performance levels of the students.

U-Tron signature Extendum T8 Fx is an all in one solution for all tube light installations. It has its own cover and connectors, thus eliminating the space required to install and casing attachment, like other tube lights. With a length of 1200mm, it is ideal for large areas. It is also ideal LED light source for hydroponic systems. Especially for the green vegetables growers. Extendum T8 Fx are sealed for water leakage and current leakage. You can use them in any wet and damp conditions without any fear of safety.

**Wiring and Installation Guide**

**Wiring Diagram:**



**Installation Instructions:**

1. Find the corresponding installation position, set the position of the clamping spring
2. Fix the clamp spring with the screw onto the surface of the ceilings 1000 mm apart.
3. Press the lamp holder into the clamping spring and install it.

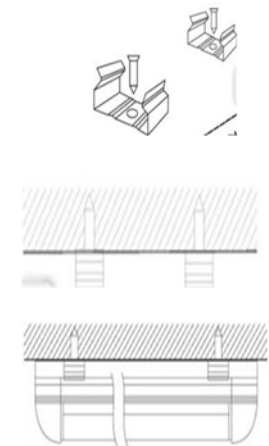

This applies to all Extendum Fx Tube light



# U-Tron Warranty

## Safety Compliance

U-Tron products meets UL, CSA, CE and CCC safety requirements: Our factories are ISO 9000 certified and follow PRC Electronics Manufacturing disciplines through out the process.



## Underwriters Lab Safety Compliance

## Canadian Safety Assurance



## China CCC certifications

## EU Commodity Compliance



U-Tron (Beijing) Electronics Co. Ltd., warrant the products listed bellow for a period of 36 months from the date of shipment to be free from defects in material or workmanship and to be of the kind and quality designated or specified in the purchase agreements. If any products do not meet the above warranty and the buyer promptly files a warranty claim U-Tron shall do the following:

1. U-Tron shall provide a 12 month “No Questions Asked” replacement of any faulty units at no charge to the customer. The time limit for exchange shall not exceed 30 days from the time a claim is filed by the buyer. The buyer shall return the faulty units within 30 days of filing the claim. The method of returning the faulty units to U-Tron shall be decided at that time by U-Tron and all shipping charges shall be borne by U-Tron.

2. At the end of the 12 month period U-Tron shall provide additional free extended warranty for another 24 months. During this 24 month period U-Tron shall repair or replace and re-certify all faulty units returned. Shipping charges for sending the units to U-Tron shall be the responsibility of the Buyer and the Shipping charges to return the repaired goods to the buyer shall be borne by U-Tron. Time limit for repairs shall not exceed 60 days.

3. The warranties set forth herein shall be voided if the units have been 1) repaired or altered by any un-authorized person 2) subjected to misuse, negligence and accidents or operated in other than normal operation and use. 3) Connected, installed or modified in a manner not in accordance with U-Tron instructions. This warranty is applicable to all LED Products.

4. U-Tron at our own option can elect to provide replacement units at any desired percentage to be warehoused and logged by the buyers for timely service of the extended warranty replacements. When the warranty expires the bad units and the unused spare parts items shall be shipped back to U-Tron unless otherwise stipulated in the contract or purchase agreements. If the warehoused quantities become 90% used up or nearing the end of stock, the buyers shall ship back the faulty units to U-Tron. U-Tron shall rotate the spare parts inventory with in 60 days of receiving from the buyers.

5. All warranty claim items shall by shipped to the buyers regardless of the geographical location, by air freight to the nearest airport or courier service to the customer site, and any returning items can be shipped by sea or air freight at the request of U-Tron. If the customer fails to return the said faulty units with in the time frame as instructed, it will be considered as sold and U-Tron reserve the rights to bill the customer for its full value.

6. U-Tron shall not bare any responsibilities with the buyer’s customer claims or shall not bare any other expenses incurred other than the units cost it self. Customer site un-installation and re-installation of any faulty units shall not be the responsibility of U-Tron.

## China Corporate Office

U-Tron (Beijing) Electronics Co. LTD.,  
20 Tianhua Yuan, Erli Erqu Suites 517-520  
Yizhuang Development Area,  
Beijing, China 100176  
+86 10 6568 2990

## Factory Address:

Maanshan U-Tron Photoelectric  
Technology Co. LTD  
259 Huxi South Road  
Maanshan City, Anhui, CHINA  
+86 555 370 8718

## For more information please contact:

Dr. Chamendra Sirimanna  
Director Of International Marketing  
Mobile Number: +86 183-0555-1170  
E-mail: Chamendra@U-Tron.com



Scan to visit the  
U-Tron official site

[www.u-tron.com](http://www.u-tron.com)



Scan to visit all Extendum T8  
LED light

