

## KiaLED *The most powerful LED Area lighting*

*Product name: KiaLED 300  
AT with 180° Vertical  
Swing Mount  
Part Number:  
68LD-140-CR4AT*



KiaLED are made with the light weight and bright Lumen LeDwali modules. Because of these unique modules U-Tron can bring you the most powerful LED lights you can find in the market today. These lights will exceed the 300 Watt mark but still keeping the weight under 10KG. And that is a very remarkable breakthrough in our industry. Furthermore, thanks to Dr. Lin and his team for the “Chips & Lens” design, this made possible to eliminate the glass cover to increase another 10% of the Light output. And it’s an all in all IP66 design to bring you worry free use of many years, indoor or outdoor.

### *Technical Specifications:*

#### **Optical Specifications:**

10 LeDwali 30W Modules; 280 XP-ER4  
Total flux:: 30,000 Lumen  
CCT: 5500 K  
CRI: >80

#### **Electrical Specifications:**

Input: 120VAC 60Hz  
(North American Version)  
Max Power 300W 10%  
PFC: 0.9min

#### **Wire Coding:**

Black: Live  
White: Neutral  
Green-Yellow: Ground

#### **Physical Specifications:**

Weight: 15Kg Max (Net weight)  
Size: 700 x 500 x 195 mm

#### **Environmental Protection:**

IP 66  
Wind Factor .05

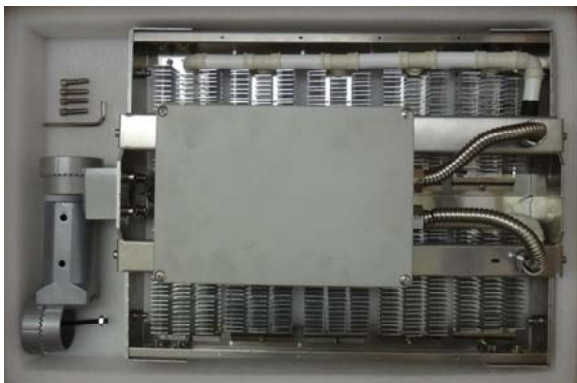

*What's in the box*

*Step by Step installation instruction*

1. Remove and save the 4 bolts on the top of the Cable box (You will need one Philips 1/4in screw driver.) Inside the Cable box locate the two 3 pin Connectors and the Ground wire connector as shown in the fig 1
2. Recommended power cable from the hand hole to the luminaries shall be 2 - #12 copper NMWU with ground, CSA approved. (Customer provided)

*If you are installing the KiaLED go to step 3. If you are installing ParkLED skip 3 and 4 and go to step 5*

3. Insert the power cable from the pole through the twistable arm and then through the cable gland on the cable box as shown in the Fig 2.
4. When inserting the power cord through the light please use the supplied nylon cable protection tube to avoid prolonged friction of cable against the metal hole on the light. Its not necessary to fasten this tube as long as its stays half way inside the twistable arm
5. Attach the long piece of the twistable arm with the long bolt and nut and position the arms to the desired angle and secure the light to the pole. Necessary Bolts and nuts are supplied with the lights.
6. Unlike the KiaLEDs you can directly attach the ParkLEDs to the poles. Please refer to the diagram shown on Figure 3.
7. Live wire or the black wire goes to the 3rd position of the 3 pin connector of the black wire connector. You must open the lever to insert the wire and close it to secure the wire. See Figure 4. Pull and test to make sure the wire is indeed securely fastened and holding in the hole. Loose wires will cause poor performance or burnout.
8. Follow the same with the white wire or the neutral wire.
9. insert the ground wire into the single wire connector which is connected with the yellow/green wire and 3 pin described above. Squeeze the connector to insert the cable and release it to snap inside. Pull and see if the wire is indeed holding in the hole.
10. It's recommended that 2 people work in tandem. Use the supplied tool and nuts to (total) to the pole and secure the light from falling.



*Figure 2: Insertion part sub assembly*

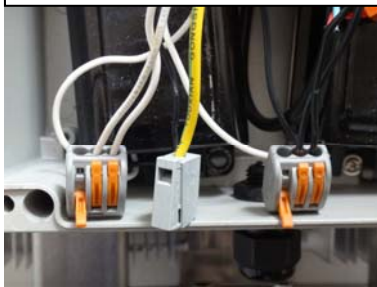

*Figure 4: Power wire Connectors*

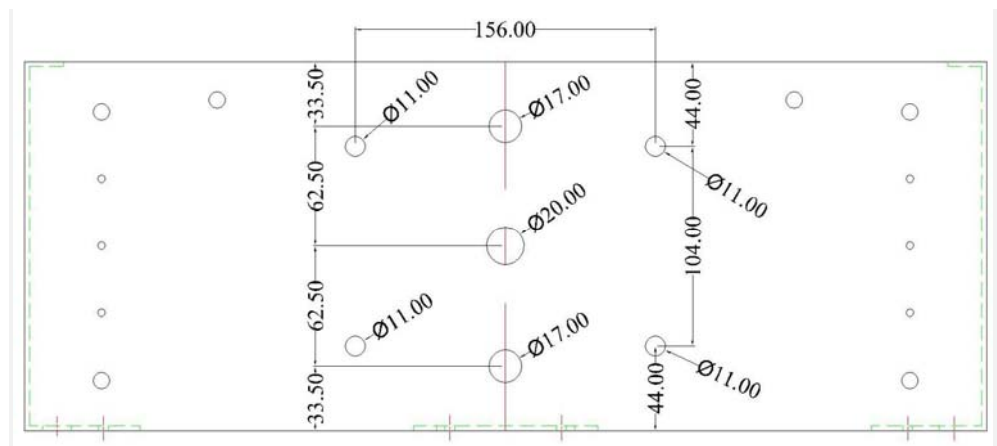

*Figure 3: Installation book-up holes*